



AUTOCAD



Gráfica_Digital

Este tutorial foi elaborado pela equipe de monitores de DIG de 2015-2

**Aline Loura,
Angélica Villon,
Bia de Assis,
Clara Coura,
Igor Dias,
Melissa Borges,
Pedro de Andrade e
Valéria Fialho**

**Professor coordenador da disciplina
Prof. Dr. Thiago Leitão**

Como configurar o layout do AutoCAD para plotagem?

Nos acostumamos a projetar utilizando o *model space* (espaço do modelo), porém, há também no AutoCAD o *paper space* (espaço do papel) que funciona justamente como se fosse a nossa folha de papel para impressão.

Nesse tutorial você aprenderá a configurar o layout para plotagem.



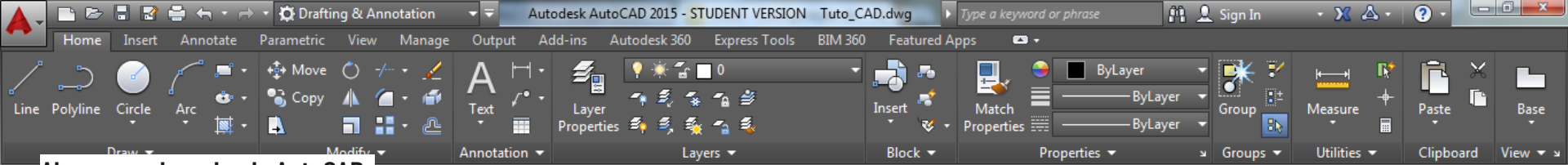

Abra o seu desenho do AutoCAD.

Agora, vamos acessar o paper space, ou layout.

No canto inferior esquerdo do programa há uma aba nomeada Model.

Se clicarmos nas duas setas apontadas pra baixo, notaremos que, por padrão, já existem o Layout1 e o 2. Escolha qualquer um deles.

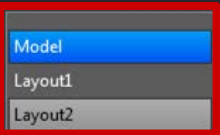
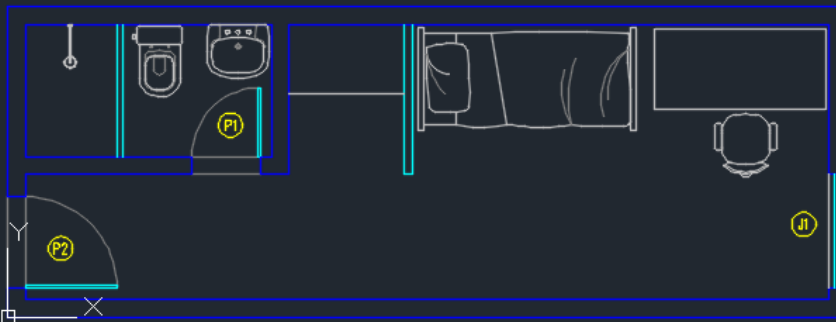

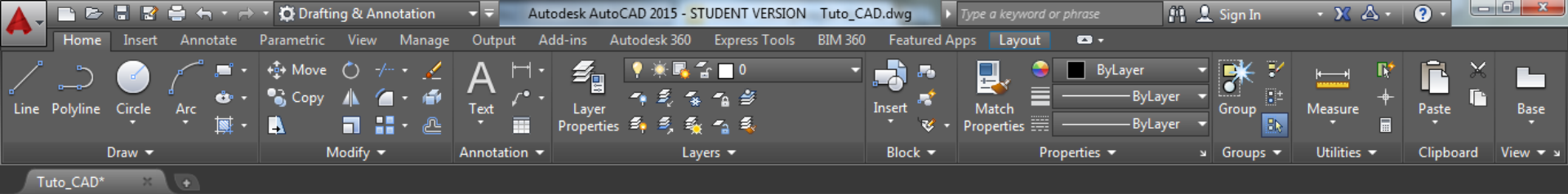

Acessamos agora o ambiente do Layout2.
Clique com o botão direito do mouse sobre a aba do layout e o renomeie se desejar.
Após renomear o layout, acesse a opção *Page Setup Manager*

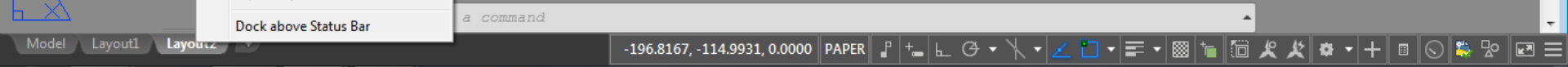
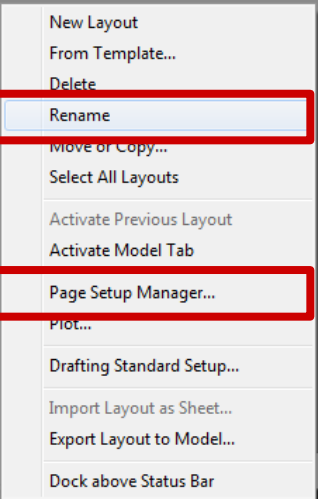
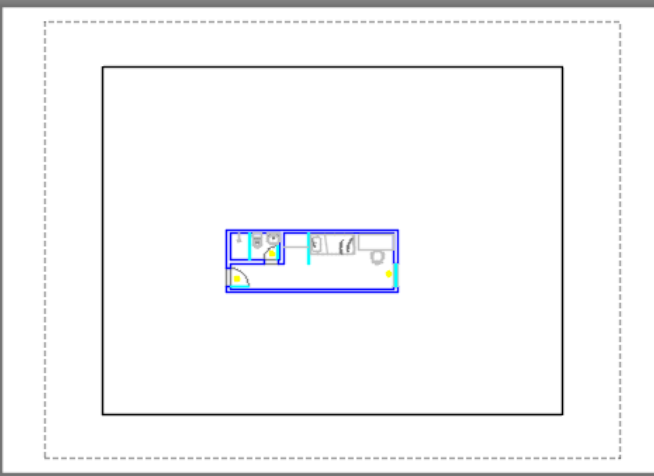

Na janela Page Setup Manager,
selecione o Layout em que estamos
trabalhando e clique no botão Modify...

Page Setup Manager

Current layout: PI Baixa

Page setups

Current page setup: <None>

Page Setup Name	Action
Layout1	Set Current
PI Baixa	New...
	Modify...
	Import...

Selected page setup details

Device name: None

Plotter: None

Plot size: 210.00 x 297.00 mm (Landscape)

Where: Not applicable

Description: The layout will not be plotted unless a new plotter configuration name is selected.

Display when creating a new layout

Close Help

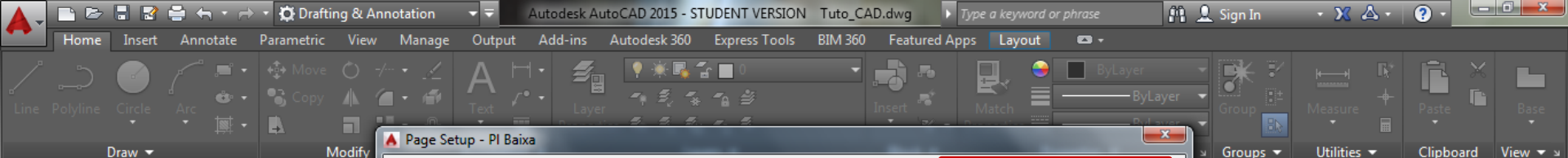

No Page Setup configuraremos o layout como para a impressão. Escolha a impressora, formato do papel, ctb, orientação do desenho, escala, etc.. No layout desenhamos em mm, a escala deve estar, portanto, sempre em 1:1. Terminadas as configurações, damos OK.

Page Setup - PI Baixa

Page setup
Name: <None>

Printer/plotter
Name: **HP Photosmart C4400 series** Properties
Plotter: HP Photosmart C4400 series - Windows System Dr...
Where: USB001
Description:

Paper size
A4

Plot area
What to plot: **Layout**

Plot offset (origin set to printable area)
X: 0.00 mm Center the plot
Y: 0.00 mm

Plot scale
 Fit to paper
Scale: **1:1**
1 mm =
1 unit
 Scale lineweights

Plot style table (pen assignments)
Ctb_1-50_Teste.ctb
 Display plot styles

Shaded viewport options
Shade plot: As displayed
Quality: Normal
DPI: 300

Plot options
 Plot object lineweights
 Plot transparency
 Plot with plot styles
 Plot paperspace last
 Hide paperspace objects

Drawing orientation
 Portrait
 Landscape
 Plot upside-down

Buttons: Preview..., OK, Cancel, Help



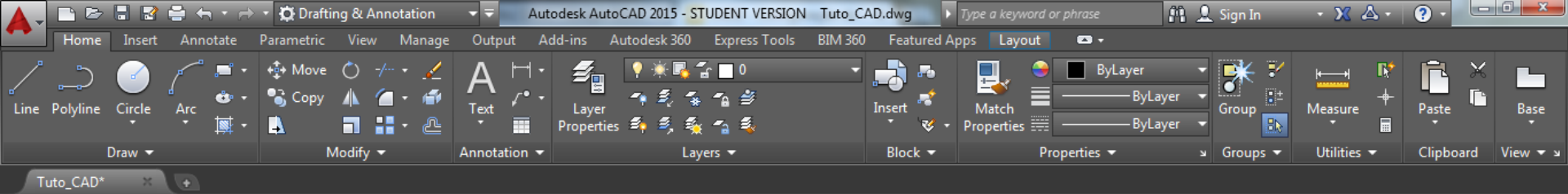

Note que agora, a folha em branco assumiu o formato que escolhemos.

Crie um novo layer para a margem e desenhe-a sobre o papel.

Não se esqueça que no layout desenhamos em milímetros.

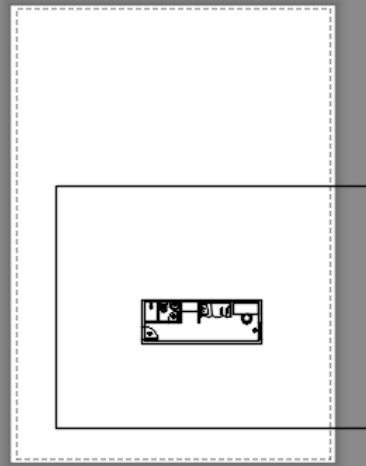

Note essa caixa que contém o nosso desenho. Essa caixa é chamada de Viewport.

Seu contorno funciona basicamente como um retângulo, podendo da mesma forma ser movida ou redimensionada.



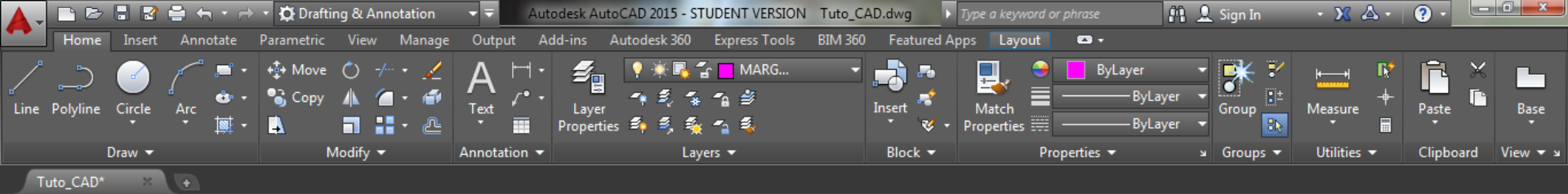

A viewport é uma espécie de janela para o model space.

Para acessar nosso desenho na viewport, basta clicarmos duas vezes dentro dela.

Observe que podemos movimentar ou mesmo modificar o desenho.

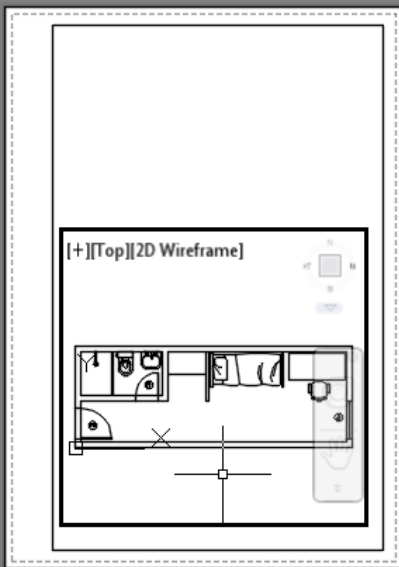

Agora vamos colocar o desenho na escala que desejamos.

Dentro da viewport digite “z” para o comando de zoom e dê Enter:

Digite “s” para a opção scale do comando zoom e dê Enter.

Agora digite 1000/escala desejada * xp.

Digite 1000/50xp para escala 1:50.

Agora, clique duas vezes fora da viewport e voltamos ao paper.

```
Specify corner of window, enter a scale factor (nX or nXP), or  
[All/Center/Dynamic/Extents/Previous/Scale/Window/Object] <real time>: s  
Enter a scale factor (nX or nXP): 1000/50xp
```

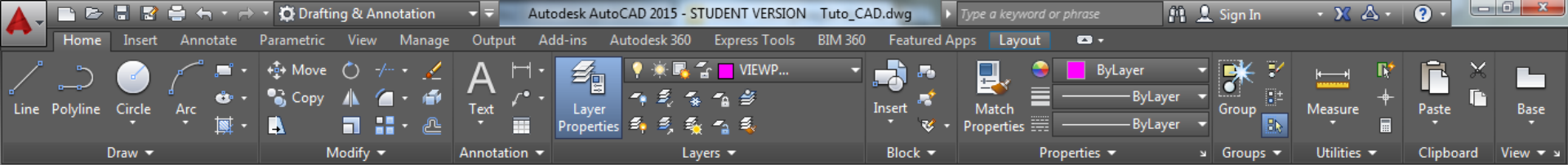

Current layer: VIEWPORT

Search for layer

Filters: All, All Used Layers

S...	Name	O...	Fre...	L...	Color	Linetype	Lineweig...	Trans...	Plot St...	P...	N...	Description	V...	VP C...
	0				wh...	Continu...	— Defa...	0	Color_7					
	ALV-CTE				blue	Continu...	— Defa...	0	Color_5					
	ESQ-CTE				cyan	Continu...	— Defa...	0	Color_4					
	HUM-MOB				9	Continu...	— Defa...	0	Color_9					
	HUM-SAN				9	Continu...	— Defa...	0	Color_9					
	MARGEM				ma...	Continu...	— Defa...	0	Color_6					
✓	VIEWPORT				ma...	Continu...	— Defa...	0	Color_6					
	PEI-VIS				9	Continu...	— Defa...	0	Color_9					
	SOL-VIS				8	Continu...	— Defa...	0	Color_8					

Invert filter

All: 10 layers displayed of 10 total layers

Agora, criaremos um layer para que as viewports não apareçam na impressão. Para isso, selecione o ícone destacado.

Command:
Command:
Command:

Type a command

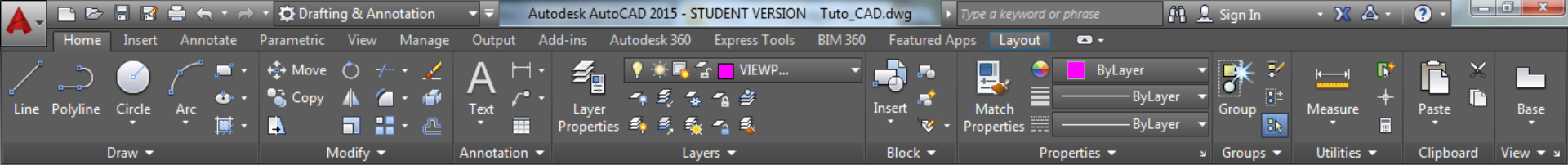

Pronto. nossa *viewport* já está configurada.

Se quisermos criar uma nova, podemos simplesmente copiar a existente ou digitar o comando VPORTS que abrirá a seguinte janela com algumas opções.

Escolha uma e dê OK.

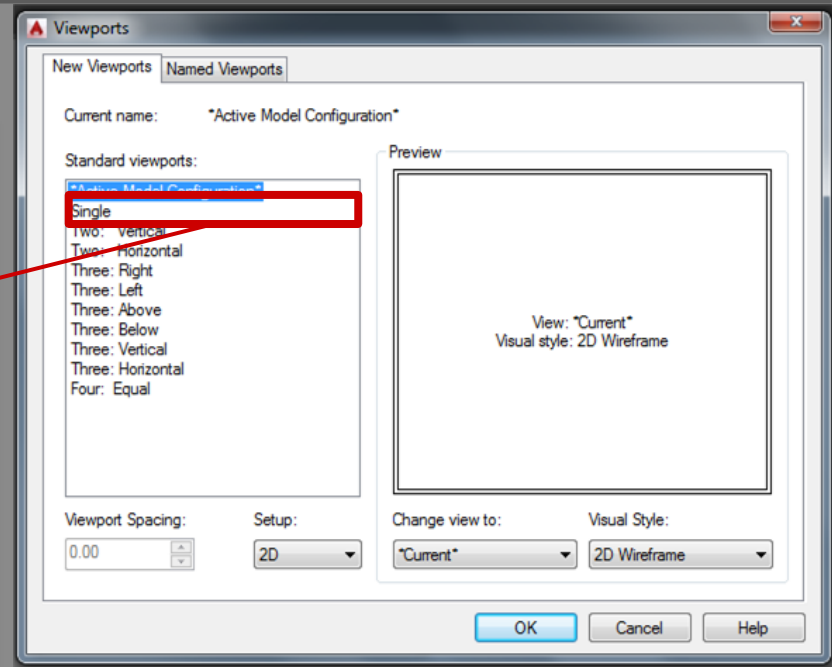
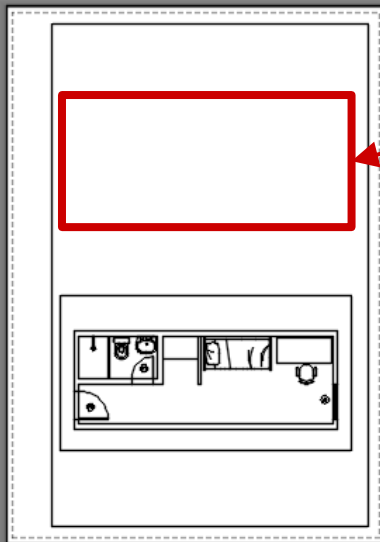

Type a command

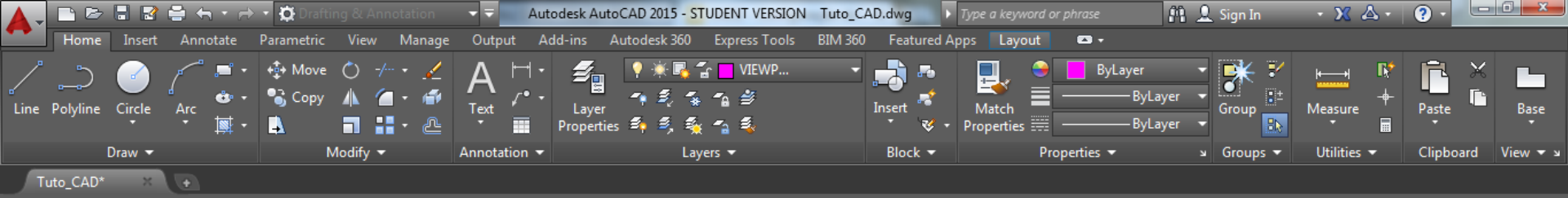

Agora basta traçar a área da viewport.

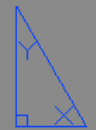
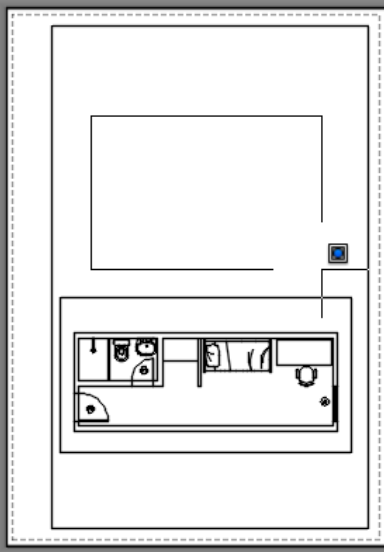

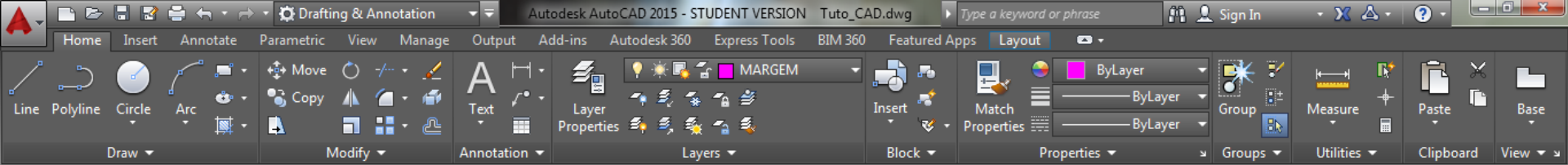

Tuto_CAD*

Podemos colocar no papel
diversas *viewports* com
desenhos diferentes e mesmo
de escalas diferentes e
organizá-los como acharmos
melhor.

Também podemos desenhar
livremente sobre o papel,
adicionando textos, linhas,
blocos, sem nos
preocuparmos com o
contorno das *viewports* que,
se no layer correto, não
aparecerá na impressão.

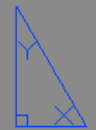
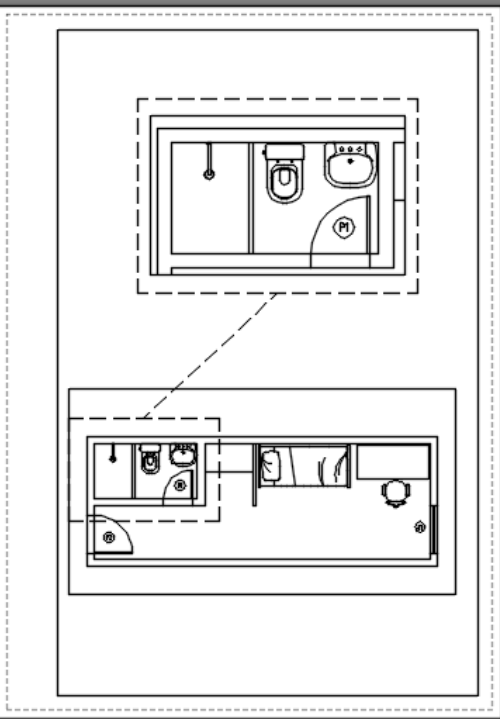

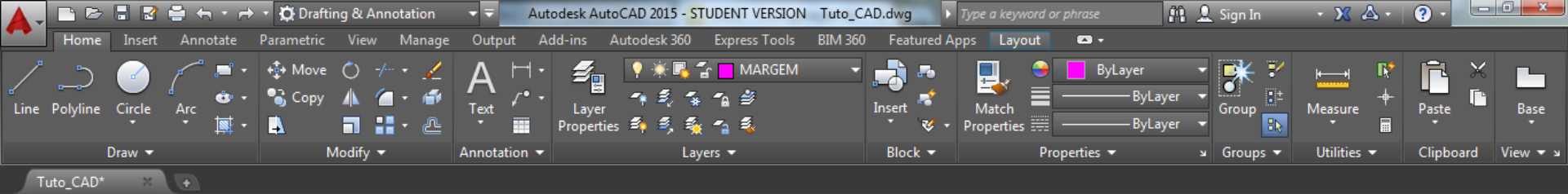

Caso desejarmos adicionar novas páginas de layout já com a configuração que fizemos, clique com o botão direito do mouse sobre a aba do layout e selecione a opção Move or Copy...

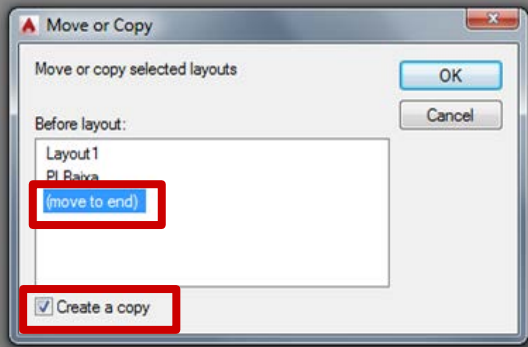
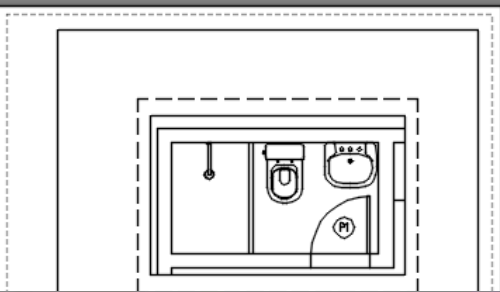
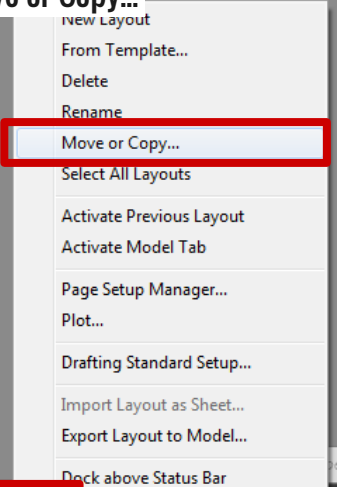



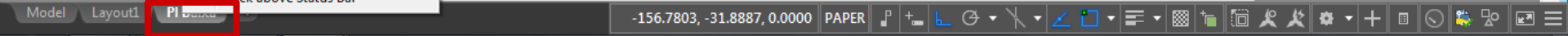



Ao abrir a janela ao lado, marque a opção Create a copy e selecione (move to end). Dê Ok.





Search Commands

Output the drawing to a plotter or other device

-  **Plot**
Plot a drawing to a plotter, printer, or file.
-  **Batch Plot**
Publish multiple sheets or drawings to a plotter, printer, DWF or PDF file.
-  **Plot Preview**
Display the drawing as it will be plotted.
-  **View Plot and Publish Details**
Display information about completed plot and publish jobs.
-  **Page Setup**
Control the page layout, plotting device, paper size, and other settings for each new layout.
-  **Manage Plotters**
Display the Plotter Manager, where you can add or edit a plotter configuration.

Options

Exit Autodesk AutoCAD 2015

Autodesk AutoCAD 2015 - STUDENT VERSION Tuto_CAD.dwg

Layout

Layer Properties Layers

Insert Match Properties Properties

ByLayer ByLayer ByLayer

Group Measure Paste Base

Utilities Clipboard View

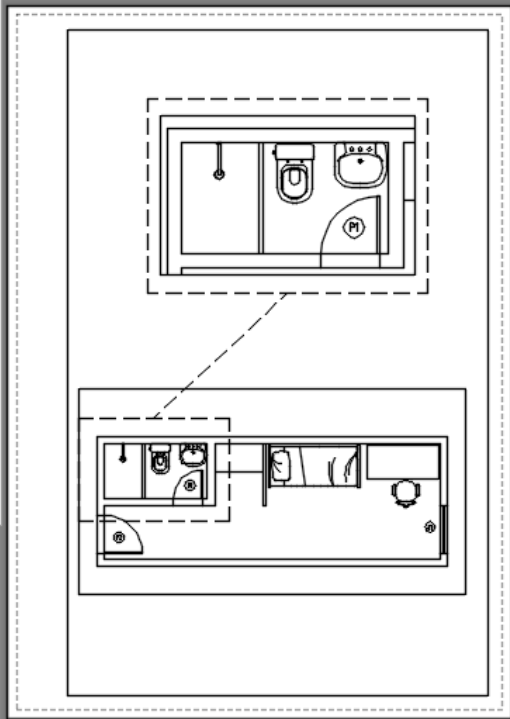

Agora, com o layout devidamente formatado, dê o comando Plot.

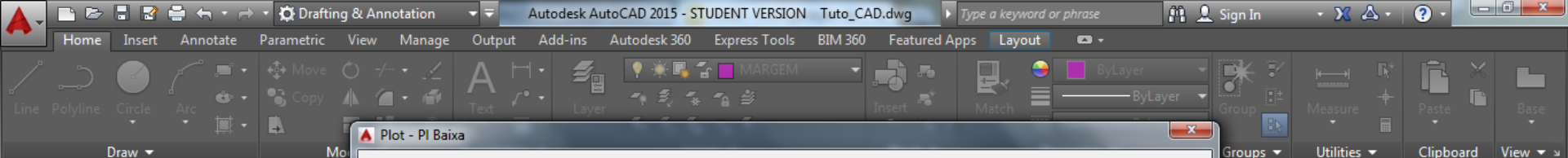

Verifique mais uma vez se todas as configurações estão corretas clicando em Preview...

Plot - PI Baixa

Page setup
Name: <None> Add...

Printer/plotter
Name: HP Photosmart C4400 series Properties...
Plotter: HP Photosmart C4400 series - Windows System Driver - ...
Where: USB001
Description:
 Plot to file

Paper size
A4

Number of copies
1

Plot area
What to plot: Layout

Plot offset (origin set to printable area)
X: 0.00 mm Center the plot
Y: 0.00 mm

Plot scale
 Fit to paper
Scale: 1:1
1 mm = 1 unit
 Scale lineweights

Plot style table (pen assignments)
Ctb_1-50_Teste.ctb

Shaded viewport options
Shade plot: As displayed
Quality: Normal
DPI: 300

Plot options
 Plot in background
 Plot object lineweights
 Plot transparency
 Plot with plot styles
 Plot paperspace last
 Hide paperspace objects
 Plot stamp on
 Save changes to layout

Drawing orientation
 Portrait
 Landscape
 Plot upside-down

Preview... Apply to Layout OK Cancel Help

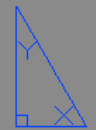

Pronto! Esse é o preview de nossa impressão em A4.

